

CONFERENCES & EVENTS

Punthill Spring Hill, Brisbane



Punthill Spring Hill
40 Astor Terrace
Spring Hill QLD 4000

Phone: 1300 964 821
Email: brisbane@punthill.com.au
Web: punthill.com.au

MEETING SPACES
CATERING
ACCOMMODATION



Located in Astor Terrace, Punthill Spring Hill in Brisbane is only a few minutes' walk to the heart of Brisbane CBD. With conference spaces accomodating 100+ guests, Punthill Spring Hill is the ideal venue for your next business event.

Our Brisbane conference facilities are further complemented by our spacious studio apartments, featuring luxurious king beds, private balconies and fully appointed kitchenettes. We also have secure undercover parking for your convenience.

Punthill Spring Hill
40 Astor Terrace
Spring Hill QLD 4000







Phone (Direct): (07) 3055 5700
Phone (Central Reservations): 1300 964 821
Email: brisbane@punthill.com.au

All inclusions and prices are correct as of date of print or delivery.
These may be subject to change



MEETING SPACE

The Green Room at Punthill Spring Hill has the advantage of natural light and access to a street-level outdoor patio area for breaks throughout the day. The conference room is complete with modern facilities & a relaxed atmosphere to ensure your event is a success.

							
Room	Area M ²	Banquet	Board	Cocktail	Classroom	Theatre	U-Shape
The Green Room	105	60	24	120	32	60	32

Facilities & Features

- > Ideal for seminars, meetings, team building workshops and training sessions
- > Natural light
- > WI-FI
- > Audio Visual equipment
- > Indoor & outdoor breakout area
- > Variety of catering options
- > Day delegate packages
- > Dedicated events team
- > Onsite car parking, subject to availability *(fee applies)*

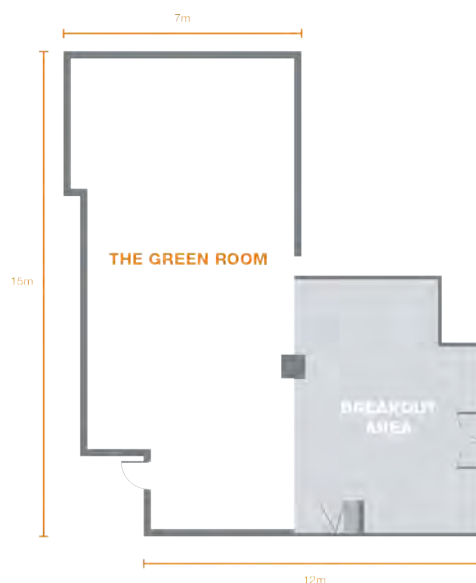

Room Hire Rates

Half-Day	\$225	8:30am - 12:30pm	or	1:30pm - 5:30pm
Full-Day	\$400	8:30am - 5:30pm		
Weekend Full-Day	\$450	8:30am - 5:30pm		





DAY DELEGATE PACKAGES

Working Package (min 15 delegates)

Full Day (4-8 hours)

\$55pp

Half Day (1-4 hours)

\$40pp

Enjoy our full day / half day delegate working package including*:

Arrival tea and coffee

Morning tea selections (choice of two options)

Working lunch

Afternoon tea (choice of two options)

**for half day, select either morning or afternoon tea*

Executive Package (min 15 delegates)

Full Day (4-8 hours)

\$65pp

Half Day (1-4 hours)

\$50pp

Enjoy our full day / half day delegate Executive package including*:

Arrival tea and coffee

Morning tea selections (choice of two options)

Executive lunch

Afternoon tea (choice of two options)

**for half day, select either morning or afternoon tea*

Dietary requirements available on request, please let us know in advance.



CATERING MENU (min \$100 order)

Beverage Options

Unlimited Nespresso coffee and tea -

\$4.50 per person

Calm and Stormy Sparkling Beverages
(Sustainably packaged)

All-Natural Sparkling Water

300ml Can - **\$3.00** per can

750ml Glass Bottle - **\$7.00** per bottle

300 ml Fruit Sparkling Can - **\$3.50** per can

Morning and Afternoon Tea

\$15.00pp (additional selection \$5.50pp)

Tea and Coffee

Juice of the day to share

Fresh Seasonal Fruit Platter to share

Select 2 of the following:

Assorted mini biscuits and slices

Assorted sweet mini muffins

Roast Veggie Frittata

Crudites, breads and dips platter

Working Breakfast Package

\$16.00pp

Each guest receives:

Mini bacon and egg rolls (2pp)

Assorted sweet mini muffins (1pp)

Fresh seasonal fruit platter to share

Juice of the day to share

Tea and Coffee

Presented on platters to share

Executive Breakfast Package

Executive Breakfast Package

\$20.00pp

Each guest receives:

Mini bacon and egg rolls (2pp)

Mini breakfast granola and yoghurt cups (1pp)

Assorted Danish Pastries (1pp)

Fresh seasonal fruit platter to share

Juice of the day to share

Tea and Coffee

Presented on platters to share

Working Lunch Package

\$23.00pp

Each guest receives:

Flat bread wraps and mixed seasonal fillings (1/2pp)

Assorted traditional sandwiches with mixed seasonal fillings (1pp)

Mini Gourmet rolls with mixed seasonal fillings

Fresh seasonal fruit platter to share

Soft drinks and juice of the day to share

We automatically include 25% vegetarian options.

Presented on platters to share.

Executive Lunch Package

\$30.00pp

Each guest receives:

Assorted Mini Gourmet rolls with mixed seasonal fillings (1pp)

Finger club sandwiches with mixed seasonal fillings (1pp)

Assorted quiches (1pp)

Fresh Garden Salad to share

Fresh seasonal fruit platter to share

Soft drinks and juice of the day to share

We automatically include 25% vegetarian options.

Presented on platters to share.

ADD ON's

Fresh Salads

All salad platters serve 8-10 guests

Fresh Garden Salad **\$40.00pp**

Greek Salad **\$45.00pp**

Chicken Caesar Salad **\$75.00**

Larger Serve - Cos lettuce, bacon, parmesan cheese,
egg, croutons and Caesar dressing

Quinoa Salad **\$45.00**

With essential greens, grains and seeds

Gourmet Platters

Minimum of 8 guests required for all platters

Fresh Seasonal Fruit Platter **\$8.00pp**

Cheese Platter **\$12.00pp**

Antipasto Platter **\$13.50pp**

Crudites, Breads and Dips Platter **\$10.00pp**

*Dietary requirements available on request, please let us know in advance.



ACCOMMODATION

Punthill Spring Hill Apartments in Brisbane are the perfect accommodation whether you're staying for business or leisure.

We offer friendly and efficient service, a spacious and stylish Brisbane hotel feel with modern décor and all the comforts of home. Complete amenities make this apartment accommodation all the more alluring.

Room Type	Configuration	Max Occupancy	Room Size
Studio Apartment	1 King	2	40m2
Superior Studio Apartment	1 King & 1 Single	3	40m2





Punthill Spring Hill
40 Astor Terrace
Spring Hill QLD 4000

Phone (Direct): (07) 3055 5700
Phone (Central Reservations): 1300 964 821
Email: brisbane@punthill.com.au

All inclusions and prices are correct as of date of print or delivery.
These may be subject to change